

1110 Double Flush Chobert

Steel - Countersunk head
3.2 mm (1/8")

Speed fastening rivet with countersunk head for use in exceptionally thin sheet materials. Based on the Chobert design, it is an ideal solution for fastening in the electronics industry and other applications where rear protrusion and rivet stem loosening are undesirable.

Features

- Flush surface on both sides of the joint*
- Reduces excess space requirements within the chassis
- Common hole form can be used throughout the chassis design to reduce complexity
- Expands radially in the material during installation
- Can be installed from either direction if accessible
- Provides superior joint strength when compared to competitive technologies
- One-piece fastener eliminates potential stem fall out that can cause electrical problems

Material

- Low carbon steel, zinc plated, clear trivalent passivated

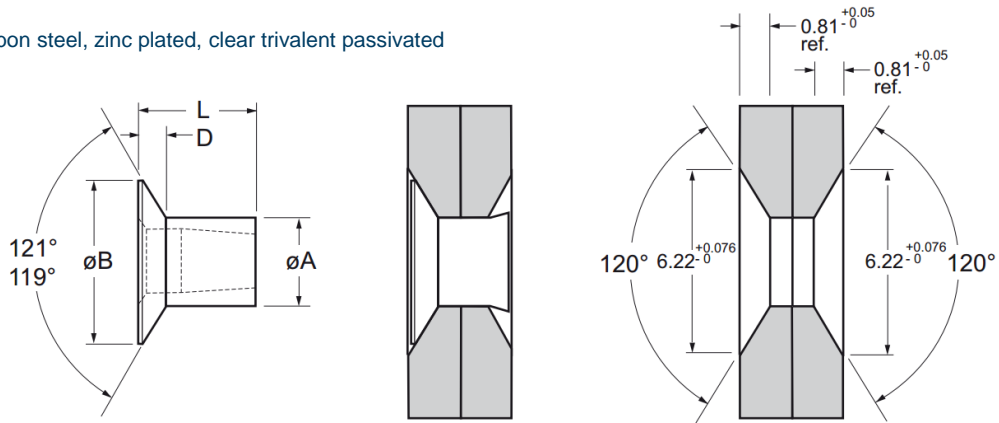

*Rear sheet tail protrusion of installed fastener is application dependent - up to 0.5 mm is permissible.

Part No.	Size ø	Grip Range		Hole Size		øB max.	D max.	L max.	øA max.	Fasteners per pod typical	Shear (typical) kN	Tension (typical) kN	
		nom.	min.	max.	min.								max.
01110-11708	3.2 (1/8")		2.00	2.67	3.26	3.34	5.46	0.76	2.49	3.25	120	1.02	1.52
01110-11294			2.41	2.92									

Assembly Applications

- Computer chassis
- Electronic devices and components
- Automotive applications
- Domestic appliances
- HVAC
- General thin sheet fabrications where material cost and blindside space is at a premium

